

# Artemide®

## VECTOR SHAPER

design  
Carlotta de Bevilacqua

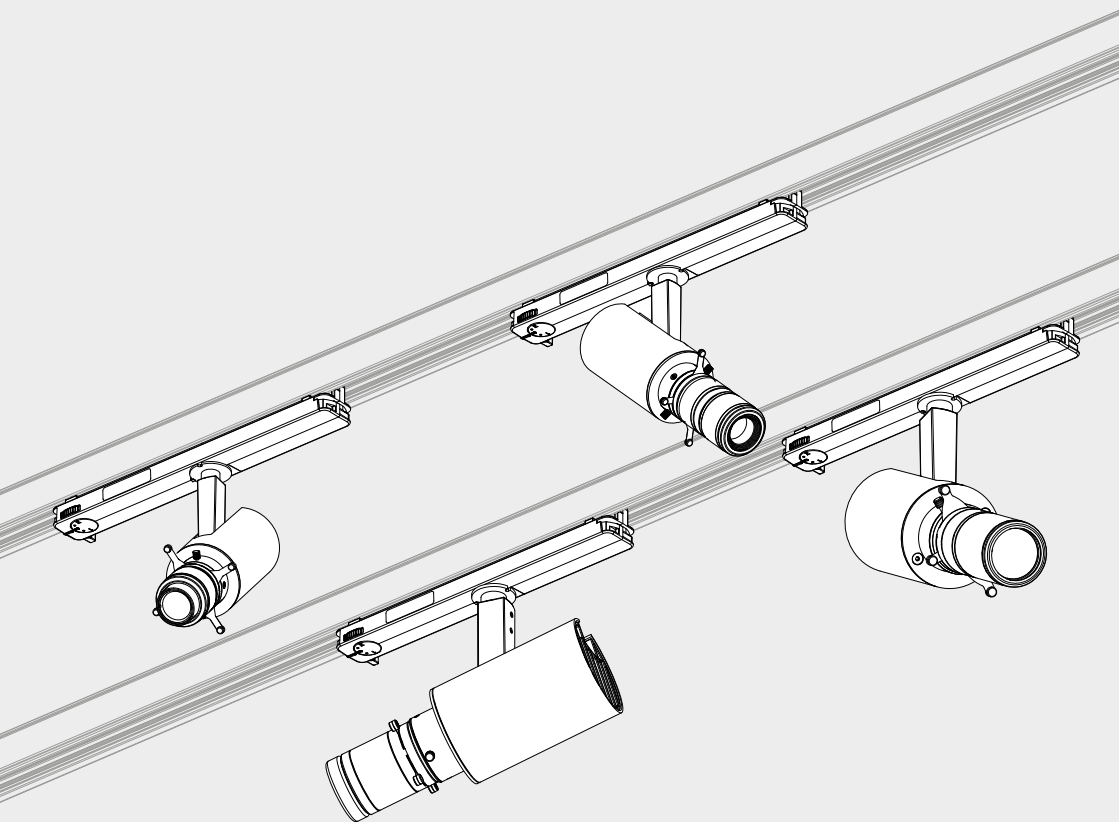



i

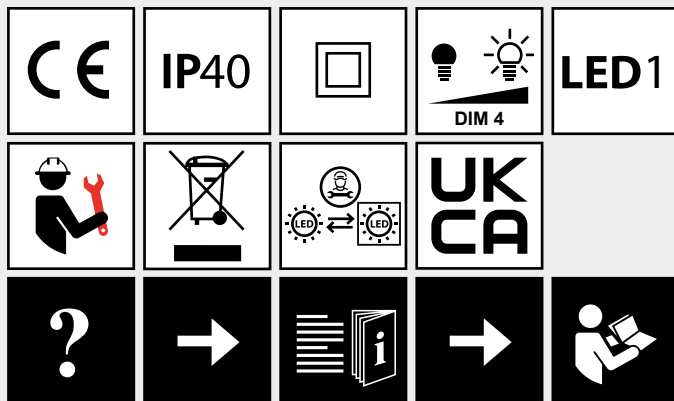

i

Output max = Max admitted power [W]	Inrush current (typ @230VAC) [A]	$t_{width}$ measured at 50% Ipeak [µsec]	Number of power unit under same MCB		
			B16A	B20A	B25A
DALI	5	50	50	62	75

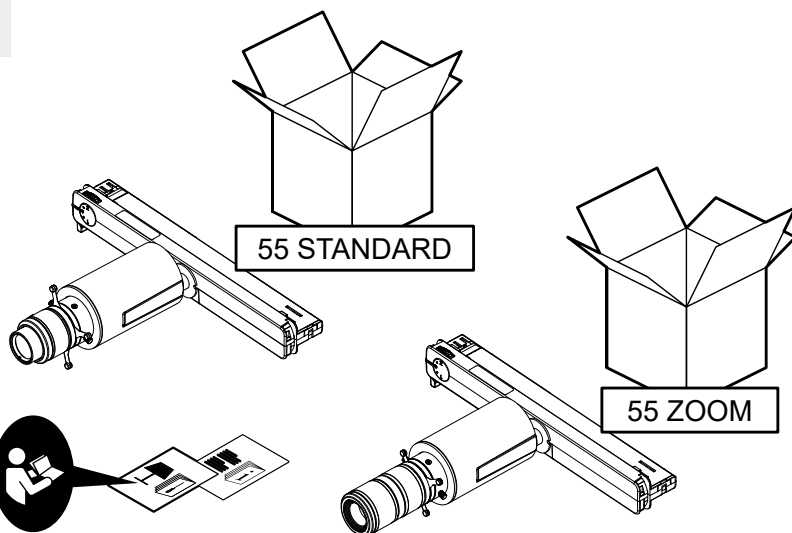

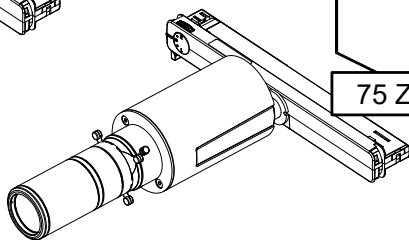
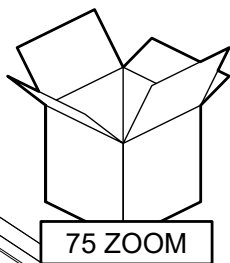
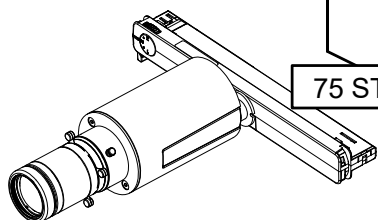
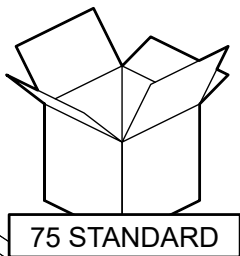
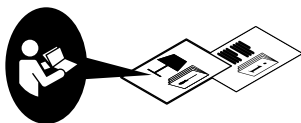

**i**

1 = L1  
2 = L2  
3 = L3

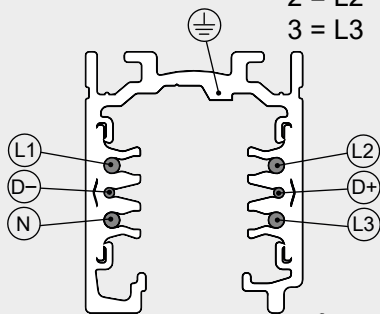

TKXXX

1 = L1  
2 = L2  
3 = L3

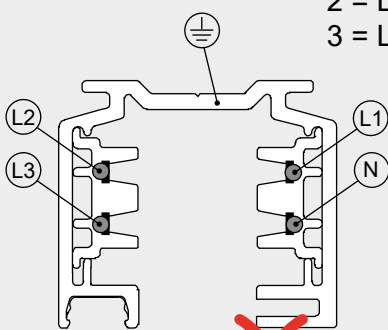

Eutrac

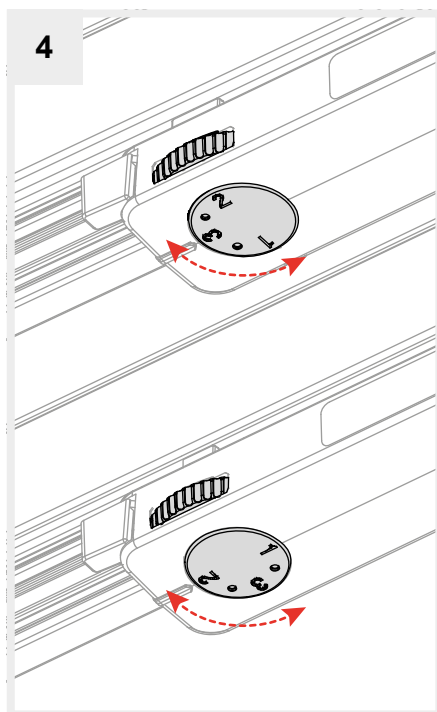
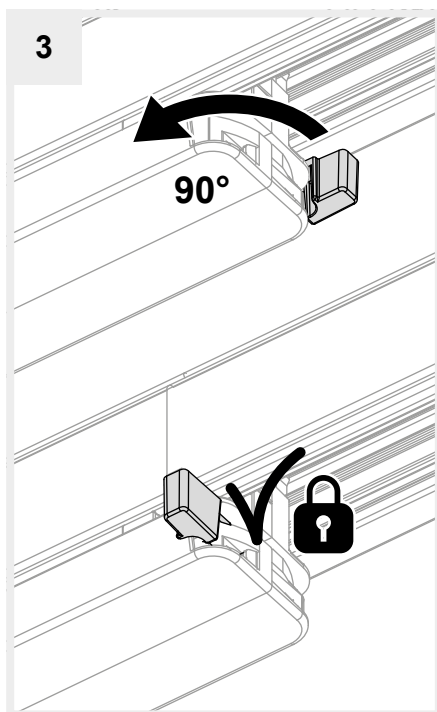
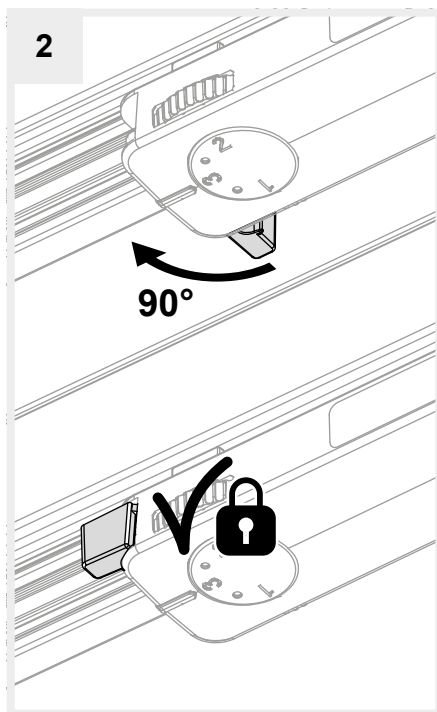
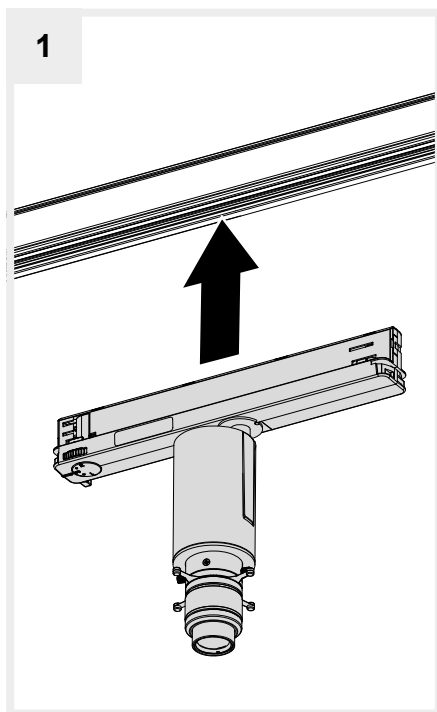

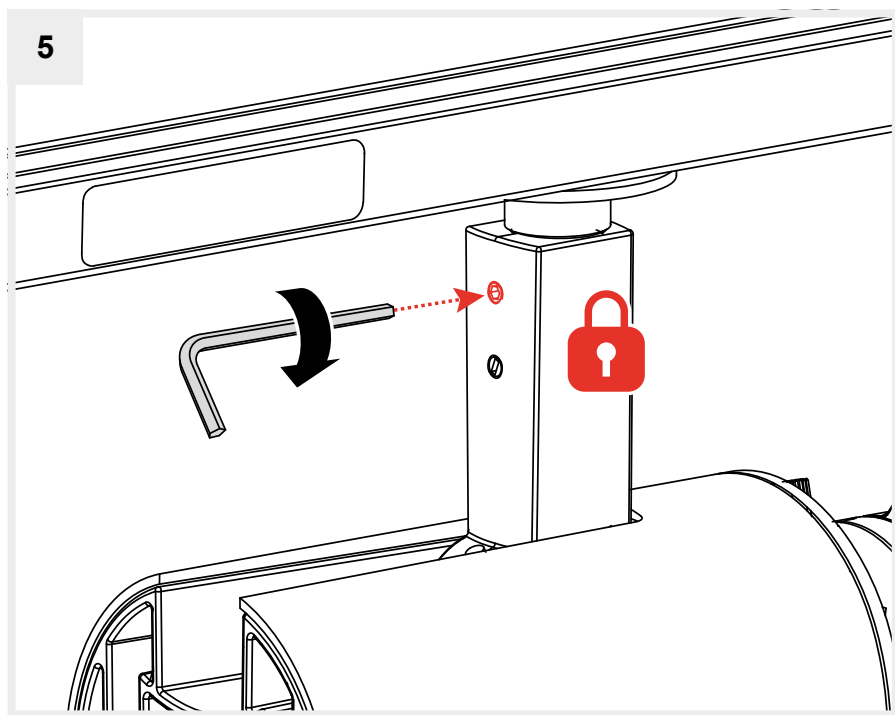
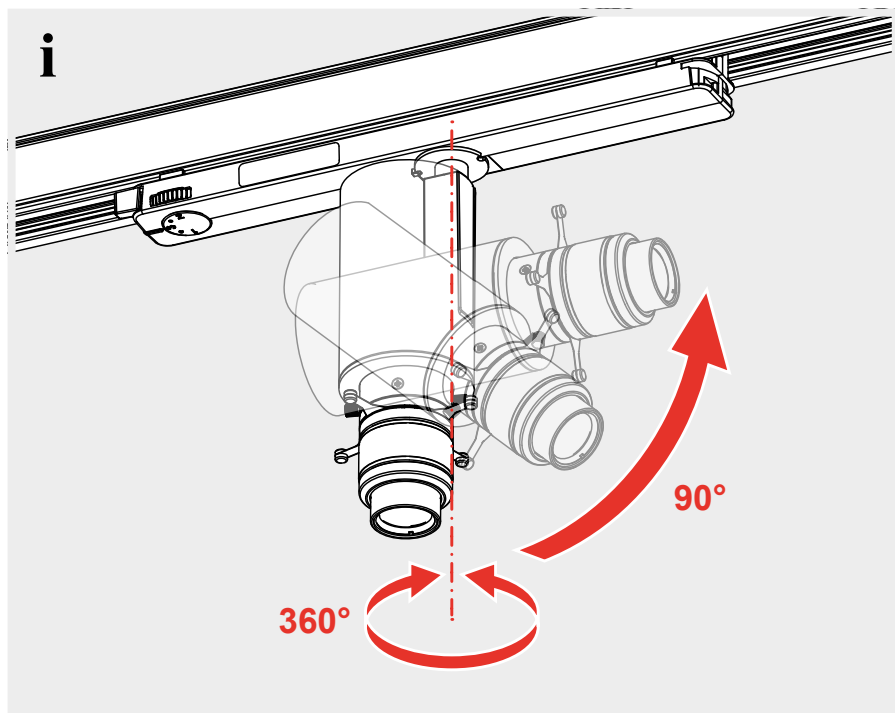

6

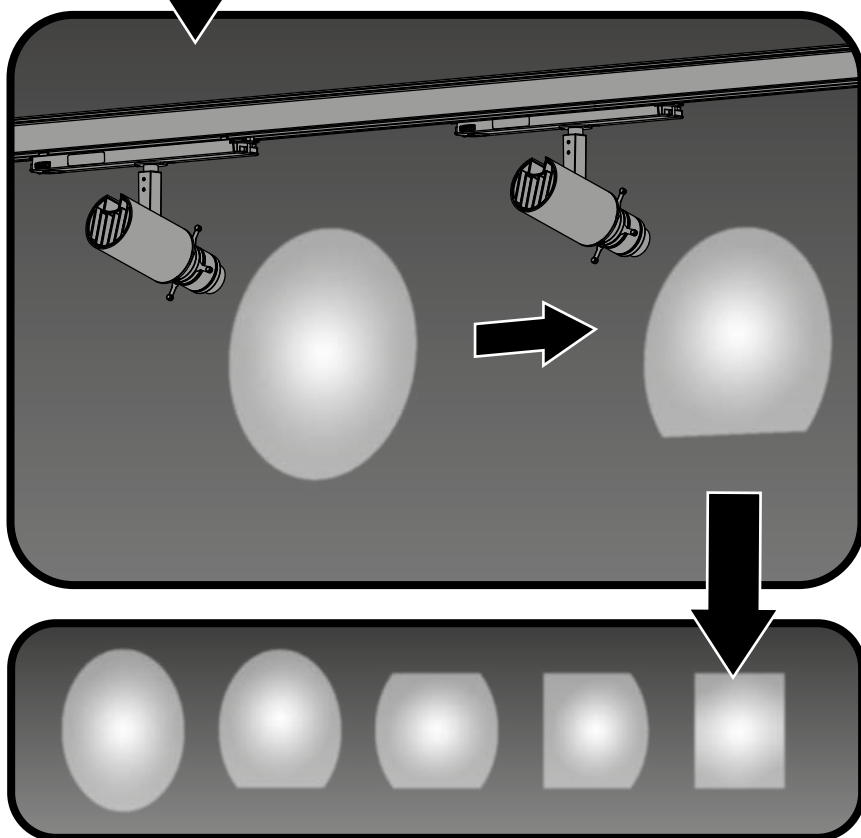
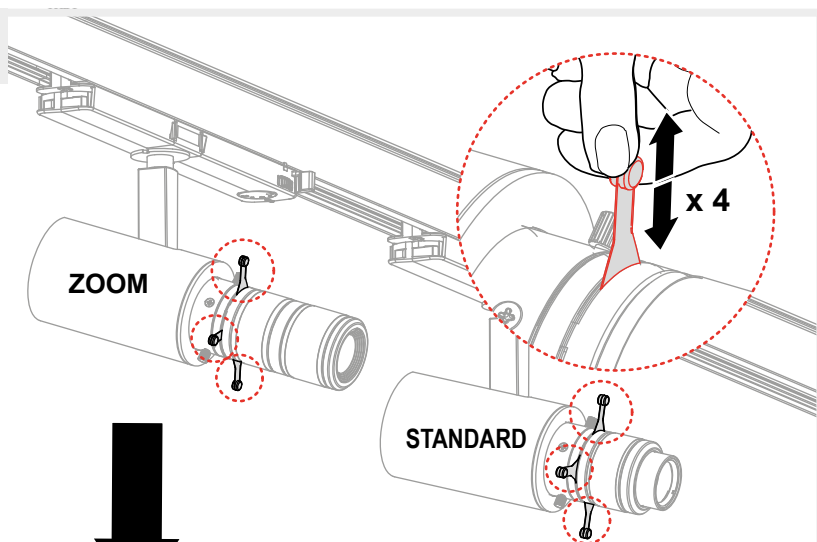

7

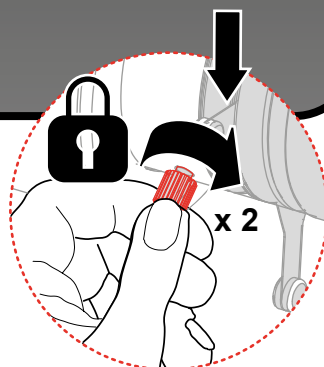
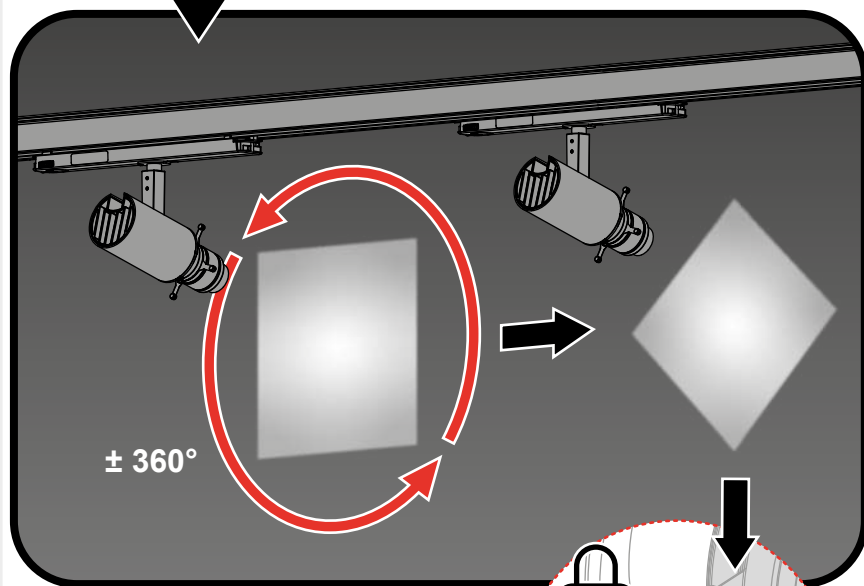
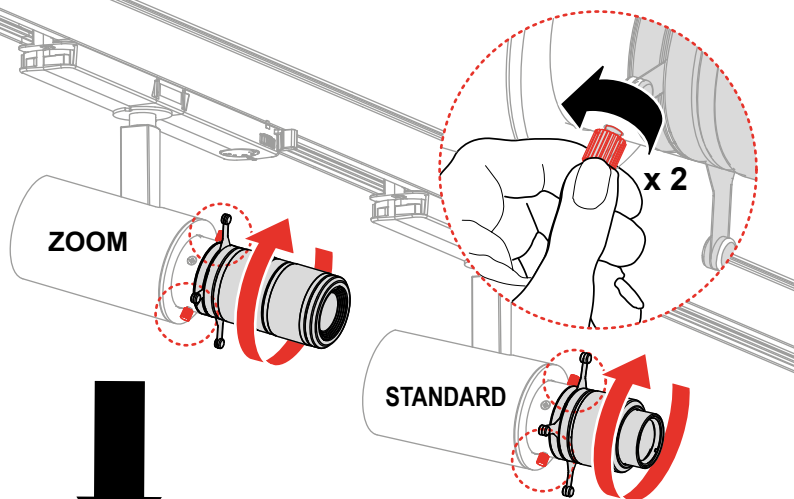

8

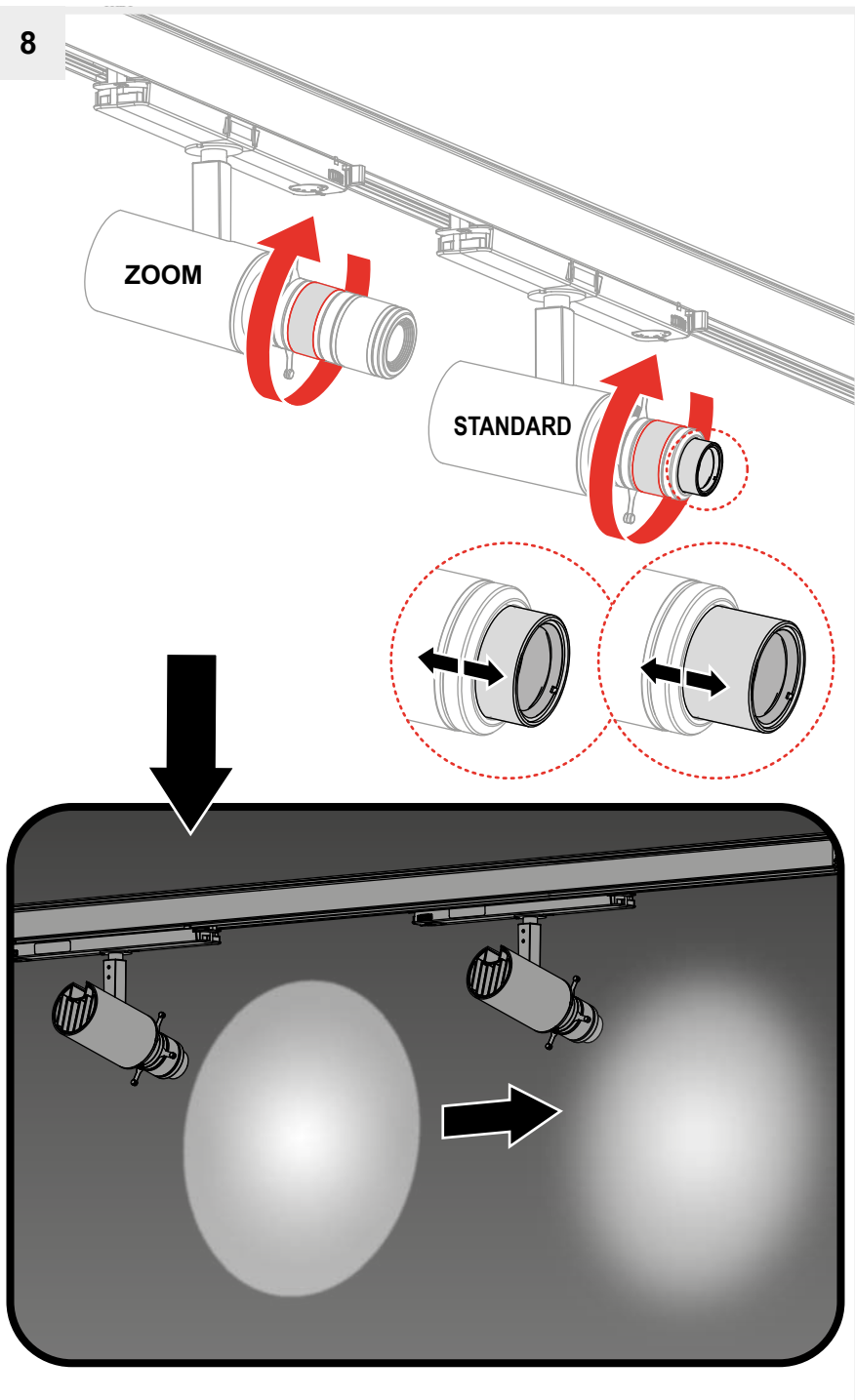



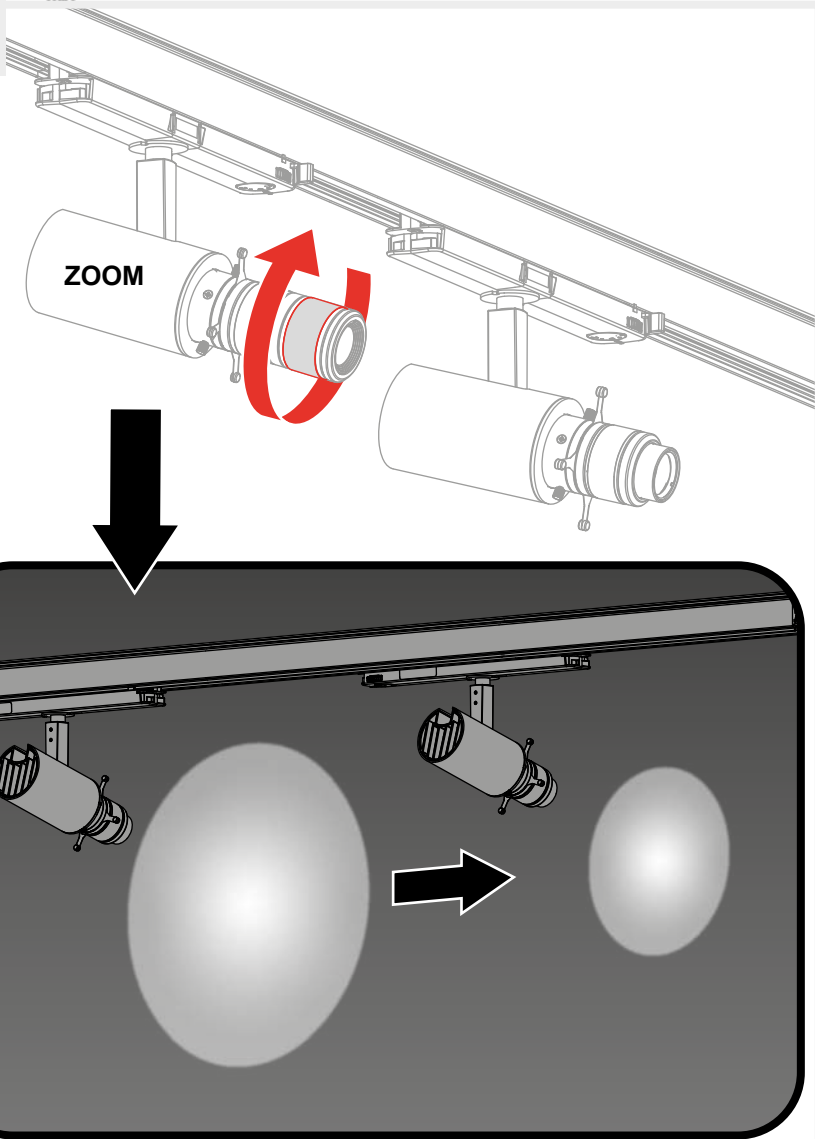



1

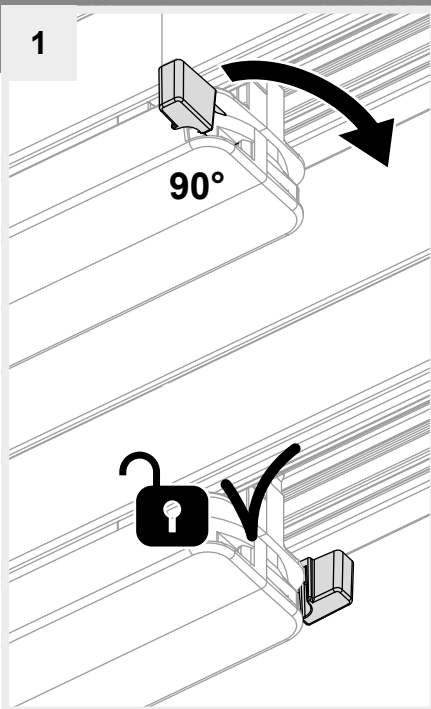

2

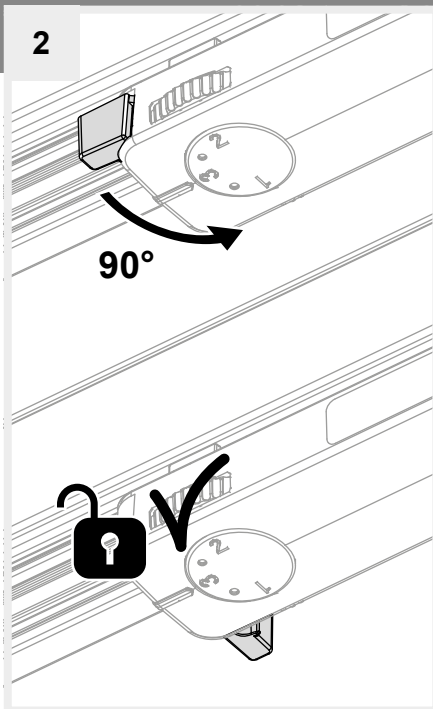

3

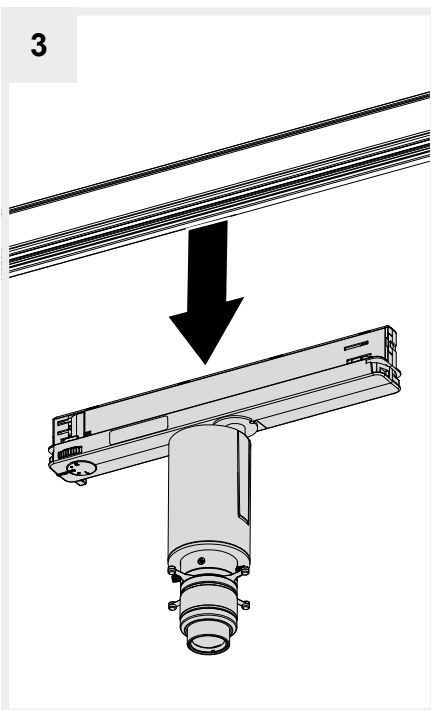

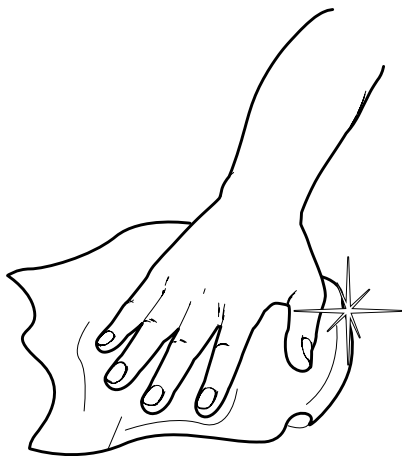
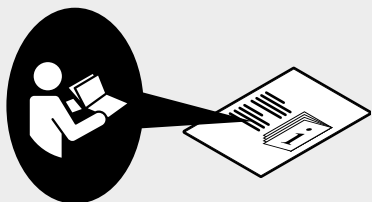

**Artemide®**



**Artemide**

via Bergamo, 18  
20006 Pregnana M.se (MI)  
ITALIA

tel. +39 02 935 181  
fax +39 02 935 90 254  
fax +39 02 935 90 496

[www.artemide.com](http://www.artemide.com)

VAT IT00846890150

cod. Y513002236